

# Threaded Flanges ANSI B16.1, Class 125

# UNITED BRAND

## BLIND FLANGE w/2" NPT

DIMENSIONS IN INCHES - WEIGHT IN LBS.

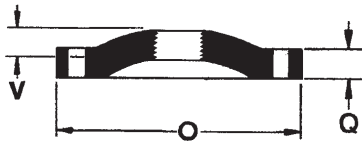
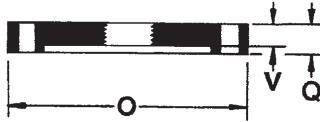

Size	Part No. (C.I.)	Part No. (D.I.)	O	Q	V	Weight
2-1/2	W-61F-0250-G	W-61F-0250-D	7.00	.68	.62	7
3	W-61F-0300-G	W-61F-0300-D	7.50	.75	.69	9
4	W-61F-0400-G	W-61F-0400-D	9.00	.94	.88	16
5	W-61F-0500-G	W-61F-0500-D	10.00	.94	.88	18
6	W-61F-0600-G	W-61F-0600-D	11.00	1.00	.94	25
8	W-61F-0800-G	W-61F-0800-D	13.50	1.12	1.06	42
10	W-61F-1000-G	W-61F-1000-D	16.00	1.19	1.12	62
12	W-61F-1200-G	W-61F-1200-D	19.00	1.25	.81	85
14	W-61F-1400-G	W-61F-1400-D	21.00	1.38	.88	120
16	W-61F-1600-G	W-61F-1600-D	23.50	1.44	1.00	145
18	W-61F-1800-G	W-61F-1800-D	25.00	1.56	1.06	185
20	W-61F-2000-G	W-61F-2000-D	27.50	1.69	1.12	245
24	W-61F-2400-G	W-61F-2400-D	32.00	1.88	1.25	370
30	W-61F-3000-G	W-61F-3000-D	38.75	2.12	1.44	500
36	W-61F-3600-G	W-61F-3600-D	46.00	2.38	1.62	790
42	W-61F-4200-G	W-61F-4200-D	53.00	2.62	1.81	1175
48	W-61F-4800-G	W-61F-4800-D	59.50	2.75	2.00	1585

## DUCTILE IRON THREADED FLANGE (for use on fabricated ductile pipe to AWWA C115)

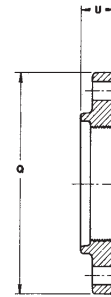
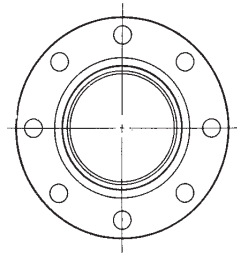

Nom. Pipe Size	Part No.	Rough O.D. of Pipe	Overall Thk. U	O.D. of Flange Q	Weight	Bolt Circle	Bolt Hole Dia.	No. of Bolt Holes
3	W-500-03-D	3.96	1.25	7.50	8	6.00	3/4	4
4	W-500-04-D	4.80	1.37	9.00	14	7.50	3/4	8
6	W-500-06-D	6.90	1.56	11.00	19	9.50	7/8	8
8	W-500-08-D	9.05	1.87	13.50	30	11.75	7/8	8
10	W-500-10-D	11.10	2.00	16.00	41	14.25	1	12
12	W-500-12-D	13.20	2.25	19.00	62	17.00	1	12
14	W-500-14-D	15.30	2.50	21.00	75	18.75	1-1/8	12
16	W-500-16-D	17.40	2.75	23.50	96	21.25	1-1/8	16
18	W-500-18-D	19.50	3.00	25.00	100	22.75	1-1/4	16
20	W-500-20-D	21.60	3.25	27.50	128	25.00	1-1/4	20
24	W-500-24-D	25.80	3.50	32.00	175	29.50	1-3/8	20
30	W-500-30-D	32.00	3.37	38.75	250	36.00	1-3/8	28
36	W-500-36-D	38.30	4.00	46.00	375	42.75	1-5/8	32
42	W-500-42-D	44.50	4.50	53.00	532	49.50	1-5/8	36
48	W-500-48-D	50.80	5.12	59.50	663	56.00	1-5/8	44

Note: Design subject to change without notice.



**WARNING:** This product can expose you to chemicals including lead, which is known to the State of California to cause cancer and birth defects or other reproductive harm. For more information go to [www.P65Warnings.ca.gov](http://www.P65Warnings.ca.gov).



**NAPAC - UNITED Distribution Centers**

229 Southbridge Street, Worcester, MA 01608

Tel: (800) 807-2215 Fax: (800) 807-2214

[www.napacinc.com](http://www.napacinc.com)