

# BOSS AND TAP LOCATIONS

METHOD OF DESIGNATING LOCATION OF TAPPED HOLES AND/OR BOSSES IN CAST IRON FLANGED FITTINGS

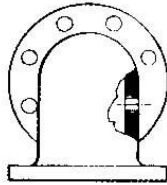

TAPPED HOLE THROUGH WALL

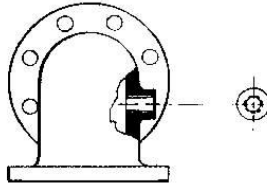

REGULAR BOSS WITH PIPE TAP

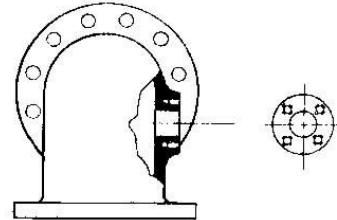

FLANGE BOSS WITH BLIND TAPPED HOLES

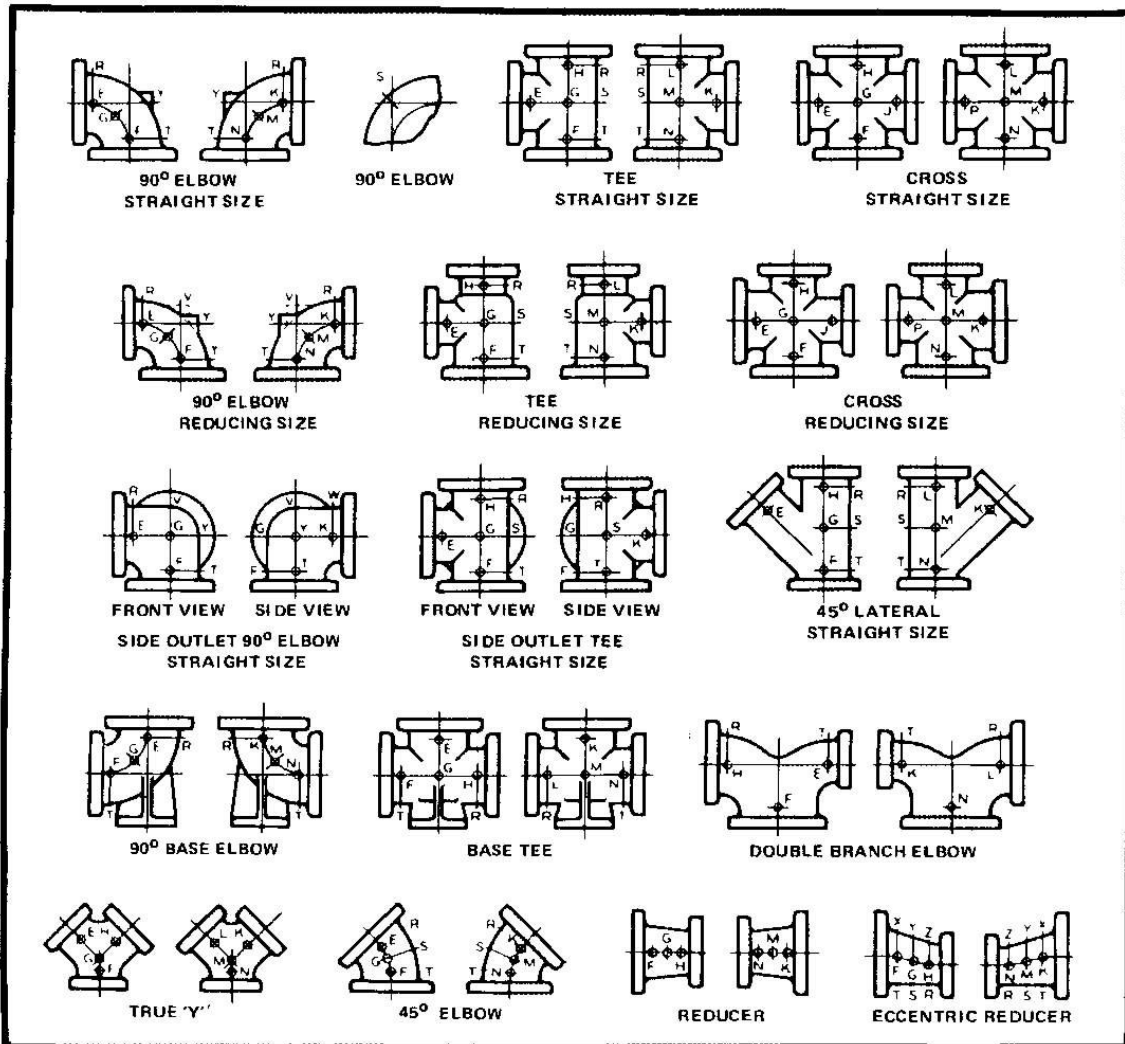

The illustrations show two views of the same fitting and represent fittings with symmetrical shapes, with the exception of the side outlet elbow and the side outlet tee.

When a cast iron flanged fitting is wanted with a tapped connection, give the size of the tapping required, and designate its location by means of a letter selected from the correct view of the fitting in question.