



90° Bend - Series 1410, PO x PO			
Size	Part No.	Weight w/o Acc.	List Price w/o Acc.
4	1410-0404	26	\$108.00
6	1410-0606	44	\$172.00
8	1410-0808	71	\$258.00
10	1410-1010	112	\$346.00
12	1410-1212	146	\$578.00
14	1410-1414	254	\$835.00
16	1410-1616	309	\$1,488.00
18	1410-1818	482	\$2,001.00
20	1410-2020	640	\$2,241.00
24	1410-2424	710	\$2,798.00



45° Bend - Series 1411, PO x PO			
Size	Part No.	Weight w/o Acc.	List Price w/o Acc.
4	1411-0404	22	\$91.00
6	1411-0606	38	\$146.00
8	1411-0808	54	\$215.00
10	1411-1010	84	\$330.00
12	1411-1212	110	\$440.00
14	1411-1414	143	\$664.00
16	1411-1616	261	\$1,031.00
18	1411-1818	309	\$868.00
20	1411-2020	397	\$1,648.00
24	1411-2424	455	\$2,042.00



22 1/2° Bend - Series 1412, PO x PO			
Size	Part No.	Weight w/o Acc.	List Price w/o Acc.
4	1412-0404	22	\$93.00
6	1412-0606	34	\$131.00
8	1412-0808	55	\$176.00
10	1412-1010	69	\$279.00
12	1412-1212	81	\$367.00
14	1412-1414	162	\$664.00
16	1412-1616	177	\$972.00
18	1412-1818	209	\$868.00
20	1412-2020	414	\$1,719.00
24	1412-2424	455	\$2,474.00



11 1/4° Bend - Series 1413, PO x PO			
Size	Part No.	Weight w/o Acc.	List Price w/o Acc.
4	1413-0404	21	\$94.00
6	1413-0606	32	\$131.00
8	1413-0808	52	\$181.00
10	1413-1010	79	\$272.00
12	1413-1212	82	\$364.00
14	1413-1414	113	\$664.00
16	1413-1616	172	\$869.00
18	1413-1818	209	\$868.00
20	1413-2020	265	\$1,100.00
24	1413-2424	315	\$3,402.00

NOTE: Shaded areas currently non-stock. Please call for availability.



90° Bend - Series 1410P, PO x PE			
Size	Part No.	Weight w/o Acc.	List Price w/o Acc.
4	1410P-0404	35	\$208.00
6	1410P-0606	50	\$196.00
8	1410P-0808	70	POA



45° Bend - Series 1411P, PO x PE			
Size	Part No.	Weight w/o Acc.	List Price w/o Acc.
4	1411P-0404	21	\$71.00
6	1411P-0606	38	\$158.00
8	1411P-0808	60	\$249.00



22 1/2° Bend - Series 1412P, PO x PE			
Size	Part No.	Weight w/o Acc.	List Price w/o Acc.
4	1412P-0404	21	\$100.00
6	1412P-0606	35	\$146.00



11 1/4° Bend - Series 1413P, PO x PE			
Size	Part No.	Weight w/o Acc.	List Price w/o Acc.
4	1413P-0404	20	\$100.00
6	1413P-0606	36	\$150.00



90° Bend - Series 1410F, PO x FE			
Size	Part No.	Weight w/o Acc.	List Price w/o Acc.
4	1410F-0404	35	\$95.00
6	1410F-0606	51	\$240.00
8	1410F-0808	74	\$271.00
10	1410F-1010	130	\$461.00
12	1410F-1212	158	\$699.00
14	1410F-1414	231	\$660.00
16	1410F-1616	233	\$967.00



45° Bend - Series 1411F, PO x FE			
Size	Part No.	Weight w/o Acc.	List Price w/o Acc.
4	1411F-0404	21	\$88.00
6	1411F-0606	42	\$187.00
8	1411F-0808	60	\$288.00
10	1411F-1010	93	\$386.00
12	1411F-1212	122	\$542.00
14	1411F-1414	162	\$673.00
16	1411F-1616	275	\$1,142.00



22 1/2° Bend - Series 1412F, PO x FE			
Size	Part No.	Weight w/o Acc.	List Price w/o Acc.
4	1412F-0404	25	\$107.00
6	1412F-0606	44	\$141.00
8	1412F-0808	64	\$241.00
10	1412F-1010	90	\$330.00
12	1412F-1212	112	\$538.00



11 1/4° Bend - Series 1413F, PO x FE			
Size	Part No.	Weight w/o Acc.	List Price w/o Acc.
4	1413F-0404	24	\$100.00
6	1413F-0606	30	\$141.00
8	1413F-0808	61	\$235.00
10	1413F-1010	80	\$310.00
12	1413F-1212	94	\$463.00

NOTE: Shaded areas currently non-stock. Please call for availability.

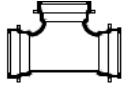

Tees - Series 1420, PO x PO			
Size	Part No.	Weight w/o Acc.	List Price w/o Acc.
4	1420-0404	46	\$156.00
6 x 4	1420-0604	58	\$199.00
6	1420-0606	66	\$209.00
8 x 4	1420-0804	93	\$265.00
8 x 6	1420-0806	103	\$297.00
8	1420-0808	109	\$347.00
10 x 4	1420-1004	95	\$411.00
10 x 6	1420-1006	129	\$444.00
10 x 8	1420-1008	141	\$528.00
10	1420-1010	145	\$655.00
12 x 4	1420-1204	115	\$512.00
12 x 6	1420-1206	164	\$464.00
12 x 8	1420-1208	166	\$582.00
12 x 10	1420-1210	175	\$665.00
12	1420-1212	193	\$647.00
14 x 6	1420-1406	176	\$652.00
14 x 10	1420-1410	195	\$703.00
14 x 12	1420-1412	196	\$706.00
14	1420-1414	209	\$1,406.00
16 x 6	1420-1606	231	\$1,216.00
16 x 8	1420-1608	265	\$1,321.00
16 x 10	1420-1610	232	\$1,375.00
16 x 12	1420-1612	300	\$1,564.00
16 x 14	1420-1614	349	\$1,352.00
16	1420-1616	261	\$1,868.00
18 x 6	1420-1806	348	\$1,445.00
18 x 8	1420-1808	325	\$1,349.00
18 x 10	1420-1810	344	\$1,428.00
18 x 12	1420-1812	344	\$2,177.00
18 x 14	1420-1814	342	\$1,420.00
18 x 16	1420-1816	362	\$1,503.00
18	1420-1818	377	\$2,594.00
20 x 6	1420-2006	355	\$1,474.00
20 x 10	1420-2010	369	\$1,532.00
20 x 12	1420-2012	425	\$1,708.00
20 x 14	1420-2014	484	\$2,009.00
20 x 16	1420-2016	510	\$2,532.00
20 x 18	1420-2018	539	\$2,237.00
20	1420-2020	564	\$3,124.00
24 x 6	1420-2406	450	\$1,934.00
24 x 8	1420-2408	492	\$3,221.00
24 x 10	1420-2410	478	\$1,984.00
24 x 12	1420-2412	541	\$2,752.00
24 x 14	1420-2414	542	\$2,250.00
24 x 16	1420-2416	566	\$2,349.00
24 x 18	1420-2418	593	\$2,461.00
24 x 20	1420-2420	628	\$2,607.00
24	1420-2424	884	\$3,669.00

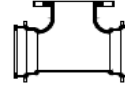

Tees - Series 1428, PO x Flange			
Size	Part No.	Weight w/o Acc.	List Price w/o Acc.
4	1428-0404	42	\$169.00
6 x 4	1428-0604	59	\$217.00
6	1428-0606	67	\$226.00
8 x 4	1428-0804	79	\$292.00
8 x 6	1428-0806	85	\$296.00
8	1428-0808	105	\$363.00
10 x 4	1428-1004	97	\$393.00
10 x 6	1428-1006	102	\$508.00
10 x 8	1428-1008	128	\$563.00
10	1428-1010	165	\$575.00
12 x 4	1428-1204	125	\$508.00
12 x 6	1428-1206	135	\$504.00
12 x 8	1428-1208	155	\$600.00
12 x 10	1428-1210	142	\$630.00
12	1428-1212	210	\$855.00
14 x 6	1428-1406	212	\$1,027.00
14 x 10	1428-1410	246	\$945.00
14 x 12	1428-1412	296	\$994.00
14	1428-1414	321	\$1,046.00
16 x 6	1428-1606	236	\$1,101.00
16 x 8	1428-1608	269	\$1,365.00
16 x 10	1428-1610	330	\$1,188.00
16 x 12	1428-1612	348	\$1,156.00
16 x 14	1428-1614	342	\$1,232.00
16	1428-1616	355	\$1,279.00
18 x 6	1428-1806	301	\$1,204.00
18 x 8	1428-1808	319	\$1,276.00
18 x 10	1428-1810	337	\$1,348.00
18 x 14	1428-1814	393	\$1,572.00
18 x 16	1428-1816	420	\$1,680.00
20 x 6	1428-2006	341	\$1,364.00
20 x 10	1428-2010	420	\$1,680.00
20 x 14	1428-2014	474	\$1,896.00
20 x 16	1428-2016	498	\$1,992.00
20 x 18	1428-2018	528	P.O.A.
24 x 6	1428-2406	512	\$2,151.00
24 x 10	1428-2410	468	\$1,996.00
24 x 12	1428-2412	503	\$2,113.00
24 x 14	1428-2414	531	\$2,231.00
24 x 16	1428-2416	555	\$2,332.00

NOTE: Shaded areas currently non-stock. Please call for availability.

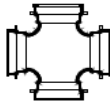

Crosses - Series 1435, PO x PO			
Size	Part No.	Weight w/o Acc.	List Price w/o Acc.
4	1435-0404	56	\$148.00
6 x 4	1435-0604	69	\$261.00
6	1435-0606	83	\$274.00
8 x 4	1435-0804	117	\$387.00
8 x 6	1435-0806	115	\$407.00
8	1435-0808	128	\$460.00
10 x 6	1435-1006	152	\$660.00
10 x 8	1435-1008	159	POA
10	1435-1010	165	\$884.00
12 x 6	1435-1206	174	POA
12 x 8	1435-1208	197	\$652.00
12 x 10	1435-1210	195	\$735.00
12	1435-1212	241	\$882.00
14 x 6	1435-1406	189	\$785.00
14 x 8	1435-1408	204	\$847.00
14 x 10	1435-1410	222	\$922.00
14 x 12	1435-1412	239	\$992.00
14	1435-1414	270	\$1,121.00
16 x 6	1435-1606	234	\$972.00
16 x 8	1435-1608	323	\$1,341.00
16 x 10	1435-1610	268	\$1,113.00
16 x 12	1435-1612	274	\$1,138.00
16 X 14	1435-1614	322	\$1,337.00
16	1435-1616	317	\$1,316.00
24	1435-2424	1178	POA

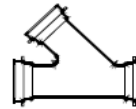

MJ 45° Lateral (Wye) - Series 1430, PO x PO			
Size	Part No.	Weight w/o Acc.	List Price w/o Acc.
4	1430-0404	53	\$146.00
6 x 4	1430-0604	83	\$339.00
6	1430-0606	85	\$418.00
8 x 4	1430-0804	89	\$424.00
8 x 6	1430-0806	120	\$577.00
8	1430-0808	125	\$688.00
10 x 4	1430-1004	141	\$480.00
10 x 6	1430-1006	151	\$630.00
10 x 8	1430-1008	175	\$834.00
10	1430-1010	200	\$750.00
12 x 4	1430-1204	178	\$794.00
12 x 6	1430-1206	201	\$835.00
12 x 8	1430-1208	224	\$915.00
12 x 10	1430-1210	240	\$1,007.00
12	1430-1212	289	\$977.00
14 x 6	1430-1406	236	\$980.00
14 x 8	1430-1408	255	\$1,059.00
14 x 10	1430-1410	325	\$1,349.00
14	1430-1414	475	\$1,972.00
16 x 6	1430-1606	281	\$1,167.00
16 x 8	1430-1608	304	\$1,262.00
16 x 12	1430-1612	346	\$1,436.00
16	1430-1616	380	\$1,577.00

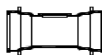

Tapped Tee 2" NPT - Series 1438, PO x PO			
Size	Part No.	Weight w/o Acc.	List Price w/o Acc.
4	1438-0404	27	\$163.00
6	1438-0606	38	\$208.00
8	1438-0808	59	\$295.00
10	1438-1010	72	\$349.00
12	1438-1212	92	\$432.00

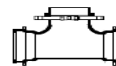

Hydrant Tee - 1429 Series, PO x Swivel			
Size	Part No.	Weight w/o Acc.	List Price w/o Acc.
6 x 6	1429-0606	65	\$241.00
8 x 6	1429-0806	100	\$415.00
8 x 8	1429-0808	110	\$457.00
10 x 6	1429-1006	130	\$540.00
10 x 8	1429-1008	156	\$348.00
12 x 6	1429-1206	162	\$577.00
12 x 8	1429-1208	158	\$656.00
14 x 6	1429-1406	202	\$839.00
16 x 6	1429-1606	229	\$951.00

NOTE: Shaded areas currently non-stock. Please call for availability.



PO Reducer - Series 1450, PO x PO			
Size	Part No.	Weight w/o Acc.	List Price w/o Acc.
6 x 4	1450-0604	23	\$108.00
8 x 4	1450-0804	49	\$155.00
8 x 6	1450-0806	52	\$158.00
10 x 4	1450-1004	53	\$300.00
10 x 6	1450-1006	54	\$234.00
10 x 8	1450-1008	84	\$259.00
12 x 4	1450-1204	55	\$330.00
12 x 6	1450-1206	89	\$278.00
12 x 8	1450-1208	96	\$301.00
12 x 10	1450-1210	82	\$363.00
14 x 6	1450-1406	84	\$303.00
14 x 8	1450-1408	85	\$307.00
14 x 10	1450-1410	87	\$314.00
14 x 12	1450-1412	104	\$375.00
16 x 6	1450-1606	144	\$640.00
16 x 8	1450-1608	141	\$664.00
16 x 10	1450-1610	145	\$650.00
16 x 12	1450-1612	135	\$685.00
16 x 14	1450-1614	139	\$577.00
18 x 8	1450-1808	142	\$590.00
18 x 10	1450-1810	151	\$627.00
18 x 12	1450-1812	167	\$694.00
18 x 14	1450-1814	217	\$901.00
18 x 16	1450-1816	202	\$839.00
20 x 10	1450-2010	180	\$747.00
20 x 12	1450-2012	205	\$851.00
20 x 14	1450-2014	233	\$967.00
20 x 16	1450-2016	250	\$1,038.00
20 x 18	1450-2018	248	\$1,030.00
24 x 12	1450-2412	337	\$1,021.00
24 x 14	1450-2414	339	\$1,167.00
24 x 16	1450-2416	340	\$1,577.00
24 x 18	1450-2418	390	\$1,619.00
24 x 20	1450-2420	421	\$1,748.00



Adapter - Series 1455, PO x Flange			
Size	Part No.	Weight w/o Acc.	List Price w/o Acc.
4	1455-0404	22	\$92.00
6	1455-0606	32	\$146.00
8	1455-0808	52	\$198.00
10	1455-1010	79	\$250.00
12	1455-1212	82	\$393.00
14	1455-1414	113	\$718.00
16	1455-1616	193	\$794.00
18	1455-1818	226	P.O.A
20	1455-2020	264	\$1,225.00
24	1455-2424	308	\$2,395.00



PO Small End Bell (SEB) Reducer - Series 1451			
Size	Part No.	Weight w/o Acc.	List Price w/o Acc.
6 x 4	1451-0604	45	\$153.00
8 x 6	1451-0806	44	\$147.00
12 x 6	1451-1206	58	\$239.00
12 x 8	1451-1208	81	\$272.00



PO Reducer - Series 1453, PO x Flange			
Size	Part No.	Weight w/o Acc.	List Price w/o Acc.
6 x 4	1453-0604	32	\$134.00
8 x 4	1453-0804	46	\$190.00
8 x 6	1453-0806	47	\$199.00
10 x 4	1453-1004	55	\$229.00
10 x 6	1453-1006	59	\$245.00
10 x 8	1453-1008	61	\$308.00
12 x 4	1453-1204	78	\$324.00
12 x 6	1453-1206	86	\$312.00
12 x 8	1453-1208	91	\$308.00
12 x 10	1453-1210	95	\$395.00
14 x 6	1453-1406	121	\$503.00
14 x 8	1453-1408	128	\$532.00
14 x 10	1453-1410	127	\$528.00
14 x 12	1453-1412	144	\$598.00
16 x 6	1453-1606	133	\$552.00
16 x 8	1453-1608	141	\$586.00
16 x 10	1453-1610	158	\$656.00
16 x 12	1453-1612	172	\$714.00
16 x 14	1453-1614	196	\$814.00
18 x 8	1453-1808	157	\$652.00
18 x 10	1453-1810	175	\$727.00
18 x 12	1453-1812	215	\$892.00
18 x 14	1453-1814	234	\$972.00
20 x 10	1453-2010	234	\$972.00
20 x 14	1453-2014	249	\$1,034.00
20 x 16	1453-2016	272	\$1,129.00
24 x 12	1453-2412	262	\$1,088.00
24 x 16	1453-2416	328	\$1,362.00

NOTE: Shaded areas currently non-stock. Please call for availability.

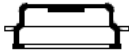

PO Caps, Solid - Series 1460			
Size	Part No.	Weight w/o Acc.	List Price w/o Acc.
4	1460-0404	10	\$47.00
6	1460-0606	18	\$73.00
8	1460-0808	25	\$113.00
10	1460-1010	34	\$145.00
12	1460-1212	45	\$212.00
14	1460-1414	70	\$237.00
16	1460-1616	98	\$736.00
18	1460-1818	120	POA
20	1460-2020	150	POA
24	1460-2424	216	POA



PO Caps, Tapped - Series 1464			
Size	Part No.	Weight w/o Acc.	List Price w/o Acc.
4	1464-0404	10	\$72.00
6	1464-0606	18	\$98.00
8	1464-0808	25	\$138.00
10	1464-1010	34	\$170.00
12	1464-1212	45	\$178.00
14	1464-1414	70	P.O.A.
16	1464-1616	98	P.O.A.
18	1464-1818	120	P.O.A.
20	1464-2020	150	P.O.A.
24	1464-2424	216	P.O.A.



PO Plugs, Solid - Series 1461			
Size	Part No.	Weight w/o Acc.	List Price w/o Acc.
4	1461-0404	10	\$36.00
6	1461-0606	18	\$59.00
8	1461-0808	25	\$80.00
10	1461-1010	34	\$126.00
12	1461-1212	45	\$144.00
14	1461-1414	74	\$424.00
16	1461-1616	86	\$554.00
18	1461-1818	120	P.O.A.
20	1461-2020	145	P.O.A.
24	1461-2424	204	\$1,380.00



PO Plugs, Tapped - Series 1465			
Size	Part No.	Weight w/o Acc.	List Price w/o Acc.
4	1465-0404	10	\$51.00
6	1465-0606	18	\$84.00
8	1465-0808	25	\$105.00
10	1465-1010	34	\$151.00
12	1465-1212	45	\$169.00
14	1465-1414	74	P.O.A.
16	1465-1616	86	\$597.00
18	1465-1818	120	P.O.A.
20	1465-2020	145	P.O.A.
24	1465-2424	204	\$1,444.00

ACCESSORIES



Push on Gasket - Series 410P			
Size	Part No.	Weight	List Price
4	410P-04-SBR	40/100	\$6.00
6	410P-06-SBR	60/100	\$6.00
8	410P-08-SBR	70/100	\$9.00
10	410P-10-SBR	90/100	\$13.00
12	410P-12-SBR	100/100	\$14.00
14	410P-14-SBR	130/100	\$26.00
16	410P-16-SBR	150/100	\$30.00
18	410P-18-SBR	330/100	\$43.00
20	410P-20-SBR	360/100	\$46.00
24	410P-24-SBR	440/100	\$49.00



Push on Transition Gasket - 410PT Series			
Size	Part No.	Weight	List Price
4	410PT-04-SBR	40/100	\$32.60
6	410PT-06-SBR	60/100	\$35.00
8	410PT-08-SBR	70/100	\$60.40
10	410PT-10-SBR	90/100	\$73.75
12	410PT-12-SBR	100/100	\$100.00