

# Swing Check Valve

## Series 7700 - AWWA C508

# UNITED BRAND

ANSI 125 Body • Bolted Cap • Bronze Seat Ring • Buna Rubber Disc Seat



Series 7700

Series 7700-LW (with lever & weight)

Series 7700-LS (with lever & spring)

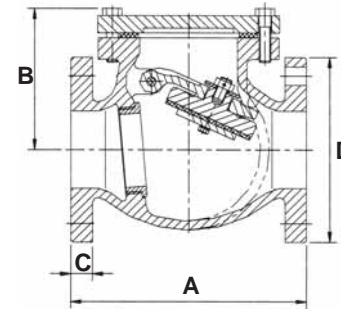
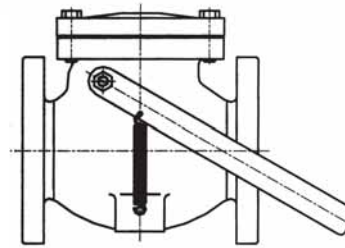
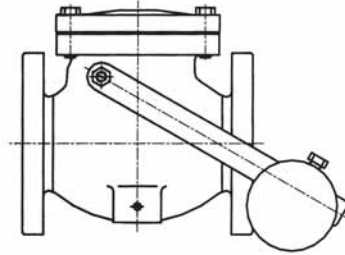

### MATERIAL LIST

ITEM NO.	DESCRIPTION	MATERIAL	ASTM SPECIFICATION
1	Hex Head Bolt	Carbon Steel	Commercial
2	Cover	Cast Iron	ASTM A126, Class B
3	Gasket	Synthetic Rubber	NBR
4	Hanger Bolt	Copper Alloy 836	ASTM B62
5	Clevis Pin	Stainless Steel	304
6A	Disc	Cast Iron	ASTMA126, Class B
6B	Disc	Synthetic Rubber	NBR
7	Hanger	Cast Iron	ASTM A126, Class B
8	Seat Ring	Copper Alloy 836	ASTM B62
9	Body	Cast Iron	ASTM A126, Class B
10	Lever	Carbon Steel	Commercial
11	Weight	Cast Iron	ASTM A126, Class B
12	Sq. Head Set Screw	Carbon Steel	Commercial
13	Packing Nut	Brass	Commercial
14	Hex Nut	Carbon Steel	Commercial
15	Hanger Shaft	Stainless Steel	304
15	Washer	PTFE	Commercial

#### NOTES:

1. Flange to specification ANSI B16.1 (125 lb.)
2. Face to face dimensions conform to AWWA C508.
3. Maximum working pressure: 200 psi
4. Suitable medium: Water/Sludge/Sewer Service
5. Coating/Lining - Fusion bonded epoxy

### DIMENSIONAL DATA

Nominal Size	Part No.	A	D	C	B
2	7700-F-110-*	8	6	5/8	4-3/4
2-1/2	7700-F-120-*	8-1/2	7	11/16	4-1/4
3	7700-F-130-*	9-1/2	7 1/2	3/4	5-1/2
4	7700-F-140-*	11-1/2	9	15/16	6-1/2
5	7700-F-150-*	13	10	15/16	7-3/16
6	7700-F-160-*	14	11	1	8-1/2
8	7700-F-180-*	19-1/2	13-1/2	1-1/8	10-1/2
10	7700-F-200-*	24-1/2	16	1-3/16	12
12	7700-F-220-*	27-1/2	19	1-1/4	13-1/2

\*Indicate LW (with lever & weight, LS (with lever & spring)

Note: Design subject to change without notice.

Dimensions in inches

*NAPAC, Inc.*

229 Southbridge Street, Worcester, MA 01608

Tel: (800) 807-2215

Fax: (800) 807-2214

# Swing Check Valve

## Series 8700 - AWWA C508 - Clear Waterway

Resilient Seat - 300 psi - Flanged Ends

# UNITED BRAND

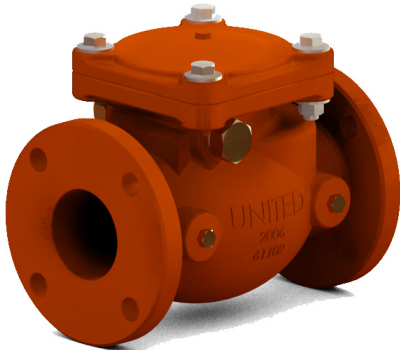

### MATERIAL LIST

ITEM NO.	DESCRIPTION	MATERIAL	ASTM SPECIFICATION
1	Body	Ductile Iron	ASTM, A536 65-45-12
2	Cover	Ductile Iron	ASTM, A536 65-45-12
3	Gasket	EPDM	Commercial
4	Clapper Arm	Ductile Iron	ASTM, A536 65-45-12
5	Disc Ring	EPDM	Commercial
6	Disc	Ductile Iron	ASTM, A536 65-45-12
7	Retainer Washer	Bronze	ASTM, B62
8	Hinge Pin	Stainless Steel	AISI, 304
9	Plug Washer	PTFE	Commercial
10	Seat Ring	Bronze	ASTM, B62

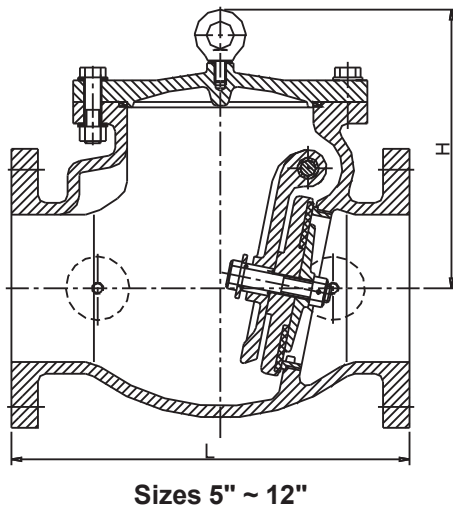
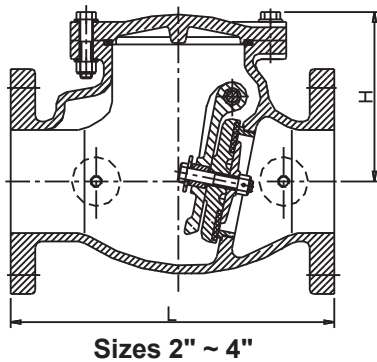

### DIMENSIONAL DATA

Nominal Size	Part No.	L	H
2	8700-F-110	8	5-3/16
2-1/2	8700-F-120	10	5-11/16
3	8700-F-130	11	5-7/8
4	8700-F-140	13	6-7/8
5	8700-F-150	14	11-3/4
6	8700-F-160	16	11-13/16
8	8700-F-180	19-1/2	13-7/8
10	8700-F-200	22	15-9/16
12	8700-F-220	26	17-1/2

#### NOTES:

1. Flange shape and drilling to specification ANSI B16.1 (125 lb.)
2. Face to face dimensions conform to AWWA C508, Clear Waterway
3. Maximum Working Pressure: 300 psi
4. Fusion Bonded Epoxy Coated, Interior and Exterior

Note: Design subject to change without notice.

Dimensions in inches

**NAPAC, Inc.**

229 Southbridge Street, Worcester, MA 01608

Tel: (800) 807-2215

Fax: (800) 807-2214